

# THE MOLD TEMPERATURE CONTROL EXPERTS





# From the start

We have been a leading and influential player in the field of contour-tracking temperature control right from the outset.

We recognised the huge potential for process optimisation in this area at an early stage, as evidenced by the constant growth of our company, as well as a lively and growing interest in our technical solutions.

Our temperature control solutions are in successful and reliable use in the production of thousands upon thousands injection molded parts. The demands to the resulting product quality, under consideration of cost-effectiveness, form the foundation for all projects.

Take advantage of our expertise!

Reiner Westhoff

Thorsten Müller-Schmetz





# CONTURA

## old Temperature



The CONTURA MTC GmbH management has been involved in process optimisation for plastic injection molded parts for many years. Both are looking back on an exciting career, full of fond memories. For them, the top priority has always been to gather **EXPERIENCE**.







# The project workflow

## Project scheduling

You, the customer, submit the relevant data and specifications to us; from this point in time, we will take care of all of the following:

- **Design**
- **Time management**
- **Consulting**

## Construction, Simulation

The envisaged temperature control is designed by way of state-of-the-art CAD systems. Special simulation techniques permit the initial visual testing and display of the flow of the temperature control agent through the cooling channels.

## Preparation of insert blanks

After release of the design data, the mold insert is manufactured. Our reliable and long-standing partners will perform this work in close cooperation with us. The production process is tailored to the requirements of the mold insert.

## The result...

a mold insert that meets the highest standards of product quality and efficiency.

Optimise your injection molding processes in cooperation with CONTURA MTC.

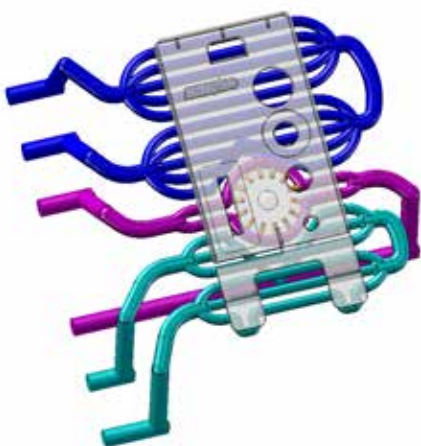



# Exemplary performance!

Variotherm yields amazing quality gains.

The screen shown here demonstrates the advantages very well.

The recesses in the screen simply provoke unwanted weld lines. The locally defined heating and cooling of the mold insert by way of different circulation systems permit the visual elimination of such features (flow lines, streaks, mediocre surface finish).





## ... perfect surfaces

In addition to shortened cycle times, the improvements in look and feel are also significant (see optical screen illustration).

Some requirements can only be met using Variotherm processes.

High gloss finish is one of the current keywords in this context.

Please get in touch for further information.

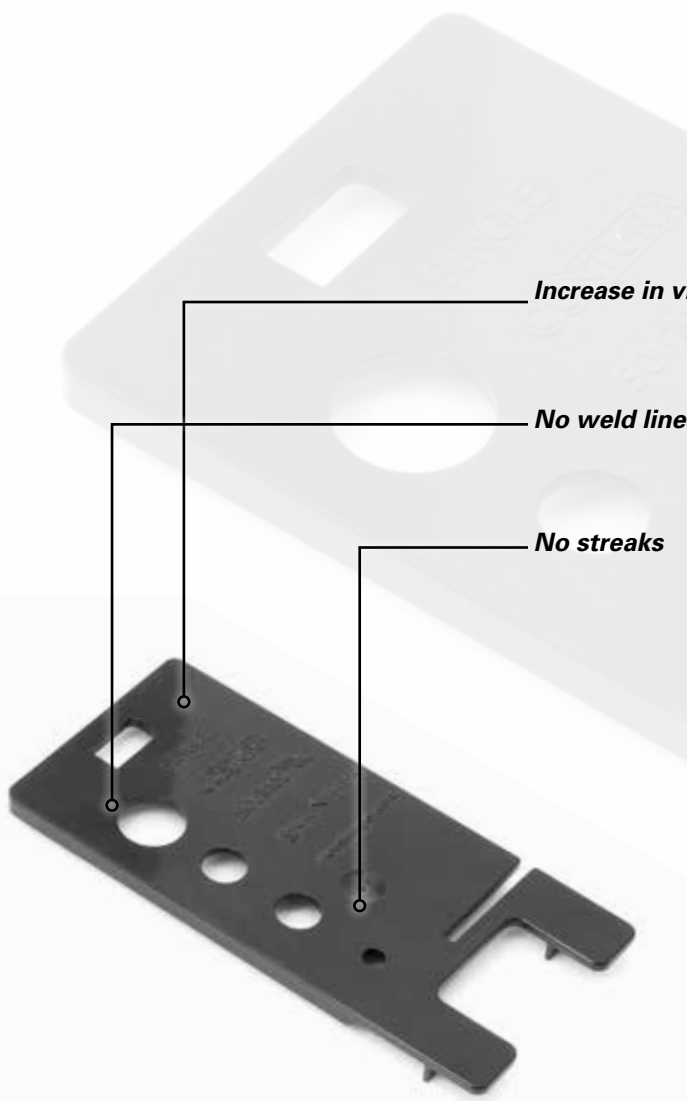





# Specifics

The use of contour-tracking temperature control is the source of real competitive advantage for our customers.

The product samples shown here\* serve as a first impression of our range of services.

\* Sample partial images courtesy of our clients.







Automotive

Household appliances

Medical technology

Packaging

Electrical engineering

Furniture

BRITA  
Julius Blum  
Continental  
Daimler  
Delphi  
Durable  
Edding  
Gardena  
Geberit  
GIRA  
HELLA  
HILTI  
Husqvarna  
Leifheit  
Magna  
Niko B.V.  
Philips  
Rehau  
Stabilo  
Staedler Mars  
Siemens  
Stihl  
Valeo  
Volkswagen  
Würth  
...



# TECH NIK UM



The CONTURA Technikum is a landmark in the history of our business, permitting on-site inspections, discussions and testing.

This was our vision, and we were finally able to make it a reality in 2016. Ultimately, we undertook the effort with a single goal in mind: To grant you, our customers, complete satisfaction.

The connected seminar room and the building concept is designed for optimal use of the Technikum.

Make yourself a picture - we are pleased to present constructive solutions in the CONTURA-Technikum.







# Short distances

Excellent communication, bright rooms, and clear lines of thought - those were the stated goals for the Technikum, and we managed to achieve them.





**CONTURA<sup>®</sup>**

**Mold Temperature Control**

CONTURA MTC GmbH  
Hämmerstraße 6 · D-58708 Menden

Tel.: (0 23 73) 3 96 46 - 50 · Fax: (0 23 73) 3 96 46 - 70

[info@contura-mtc.de](mailto:info@contura-mtc.de)

[www.contura-mtc.de](http://www.contura-mtc.de)